



## Lamboo® Titan™ Clip Rain Screen System™

### Vertical Siding Installation Guidelines using Titan™ Rain Screen Clip on Plywood or OSB

*Before starting your Lamboo Rain Screen installation, check that these important items have been done properly:*

**Pre-Check 1 – Make sure your structural sheathing has been attached properly to the framed wall system per manufacturer’s instructions and local building codes.** Plywood or Oriented Strand Board (OSB) may be used. The panel thickness should be rated for structural application and must be a minimum of 7/16” thick in non-hurricane rated zones and a minimum of 5/8” in hurricane rated zones. Plywood is typically stiffer and stronger than OSB. Thicker plywood or OSB makes a stronger wall and has greater holding strength of the screw.

*Note\* Foam and gypsum boards are not structural panels. (Installation of the Lamboo Rain Screen System over non-structural panels is possible using alternate mounting devices such as: Z-Girts, Hat Channel, and Pressure Treated Lumber)*

**Pre-Check 2 – Make sure the drainage plane material has been properly installed.** Use the appropriate AWB (Air and Water Barrier) or WRB (Weather Resistant Barriers) as specified by the architect or designer. There are many products available to address requirements of the exterior wall in your climate zone.

**Pre-Check 3 – All windows and exterior doors should now be installed properly.** Check to ensure that the installation (and flashing) instructions from the door and window manufacturers were properly followed. *Note\* Window and door manufacturer’s installation instructions always take precedent over these guidelines.*

**Proper acclimation is imperative.** Before starting any exterior installation, *always* allow the materials to properly acclimated to local site conditions. Failure to allow proper acclimation on site could result in poor or undesired results. Typical acclimation time for Lamboo products is at least 48 to 72 hours prior to installation.

**Keep Pre-finished Materials Sealed: This is required.** Lamboo typically provides all exterior grade materials prefinished. For all onsite surface alterations which include but not limited to; end cuts, drilling, rip cutting, cross cutting, or any other material penetrations, it is **required** that these conditions **MUST BE SEALED!** Sealing Lamboo materials can be done with touch up stains/finishes provided by Lamboo or can be sealed with other market-based end sealers. Even exterior grade silicone can be used on end conditions. As this requirement is part of Lamboo’s installation guidelines to help maintain the integrity of the finish; failure to follow these guidelines will be at the fault of the **Installer**; not Lamboo.

## Installation Process:

### **Step 1 – Install Starter Rail**

To start the wall, first measure up from the bottom of the wall 1-1/2" and place a mark at each end of the wall. Then from the end of the wall, place a mark every 4'-0" until marks have been placed along the wall. Then use a chalk line or laser level to ensure all marks are level with the wall. Begin at one end of the wall installing the Lamboo Starter Rail until you reach the other end of the wall. The Lamboo Starter Rail can be cut to fit final piece onto the wall. (Note: Be sure to use carbide tipped saw blades to cut the aluminum starter rail. Clean off any burrs left from cutting the materials.)

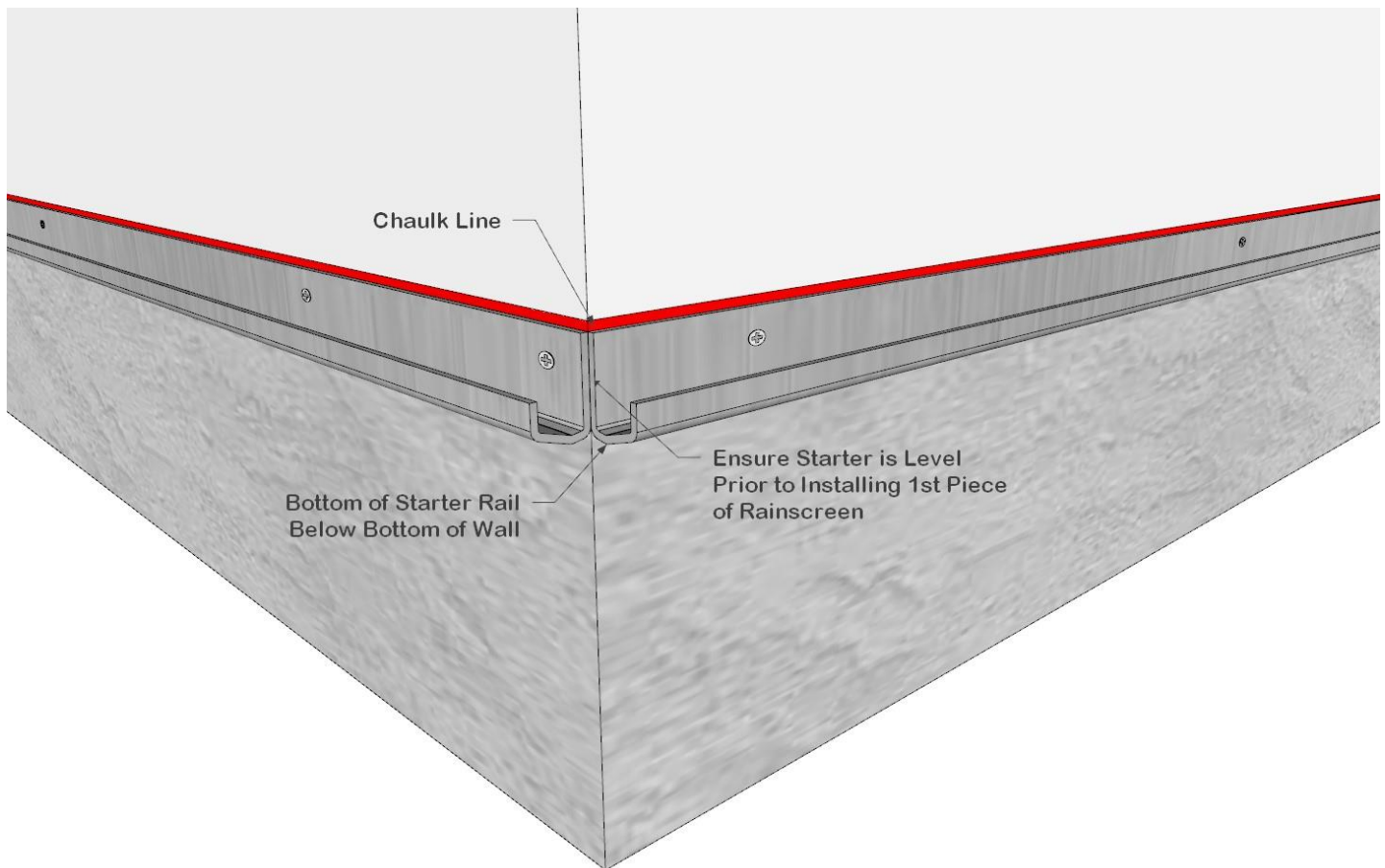

**Step 2 – Install Siding Vent and Vertical Blocking**

Install a row of the siding vent materials just above the starter rail. Secure the siding vent materials with a typical galvanized roofing nail. Now place vertical strips of the siding vent system at the end of the walls. Secure the siding vent materials with a typical galvanized roofing nail.

If wood blocking is used, the thickness of the materials must be 7/16" up to 1/2" thick. This will help keep the first and last piece of installed vertical rainscreen flush with the wall.

**IMPORTANT:** It is important to measure the overall run of the wall to determine the proper width of rainscreen to start and finish the wall to ensure that the first and last piece of the run is equal.

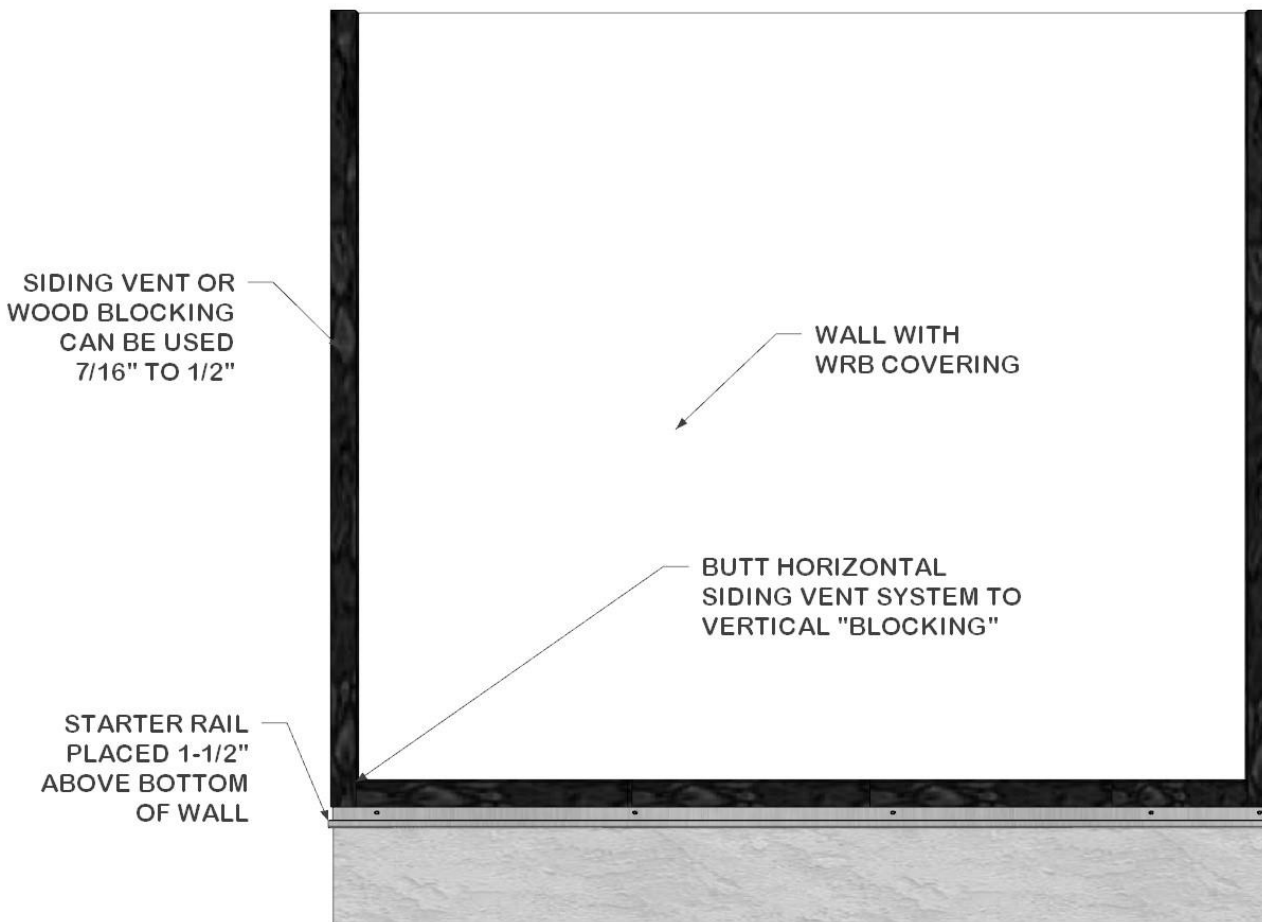

**Step 3 - Install Engineered Corners (Outside or Inside) (OPTIONAL).** If using Engineered Outside or Inside Corners, you will install these prior to installing the starter rail (*vertical blocking not required if using engineered corners*).

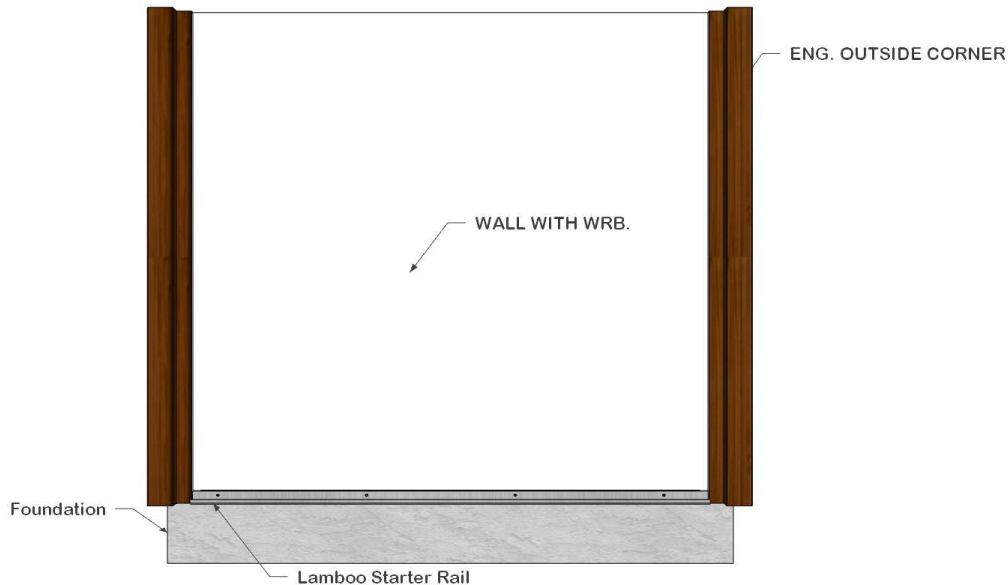

*\*NOTE: Bottom of Rainscreen should be flush with bottom of Engineered Corners*

**\*\* NOTE: If Engineered Corners are used, starter and finish wall blocking will not be necessary.**

**Step 4 – Install your window and door trim.** Lamboo offers window and door trim pieces if desired by the customer. Now is the time to install them and put proper flashing in place. Always follow the window and door manufacturer's installation and flashing instructions.

**Step 5- Determine where your vertical siding joints will align before installing your first siding board.** To avoid ending up with extremely narrow vertical siding boards around doors and windows or at the end of your siding run, you will want to determine the correct width to rip your first siding board.

**Step 6 – Router a notch at the bottom back side of each siding board prior to installation.** For vertical installations, the bottom backside of the rainscreen that seats on the starter rail will need to be notched. The depth of the notch can be anywhere from 3/4" to 1" deep; depending on how much coverage you require the bottom of the vertical siding board to conceal the starter rail. The slot depth can be anywhere from 3/8" to 1/2".

**IMPORTANT:** Cut all slots the same! Cutting slots at different lengths and depths will create an uneven bottom layer.

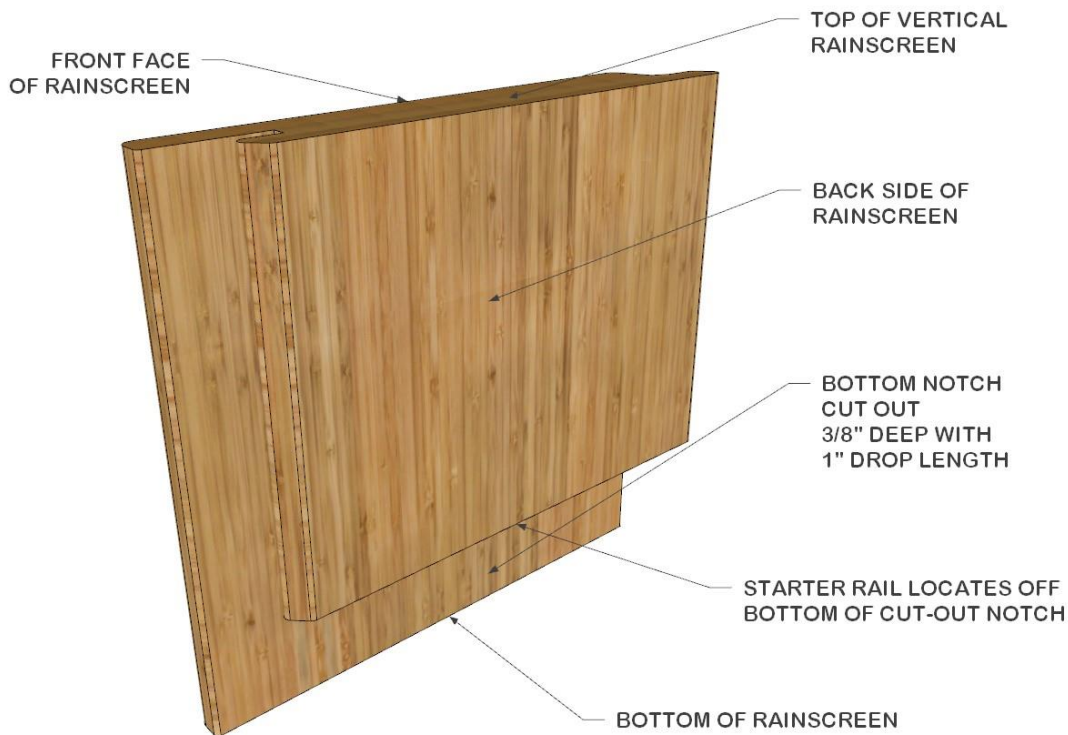

**Step 7 – Install First Piece of Lamboo Rainscreen-Vertical Application.** The vertical rainscreen system can start from left to right or vice versa. If the first piece is going to start an outside corner (which is typical), the long bottom profile of the rainscreen will need to be mitered (see picture below). Once the rainscreen piece is in position, use stainless steel fasteners to fasten the rainscreen piece to the vertical blocking piece. Start the Lamboo Titan Clips starting from top of the siding vent material just above the starter rail and space the clips vertically every 24” to 32”. (NOTE: If the rainscreen system is installed in high wind or hurricane zones, spacing of the clips may need to be closer. Confirm design wind load requirements with local PE).

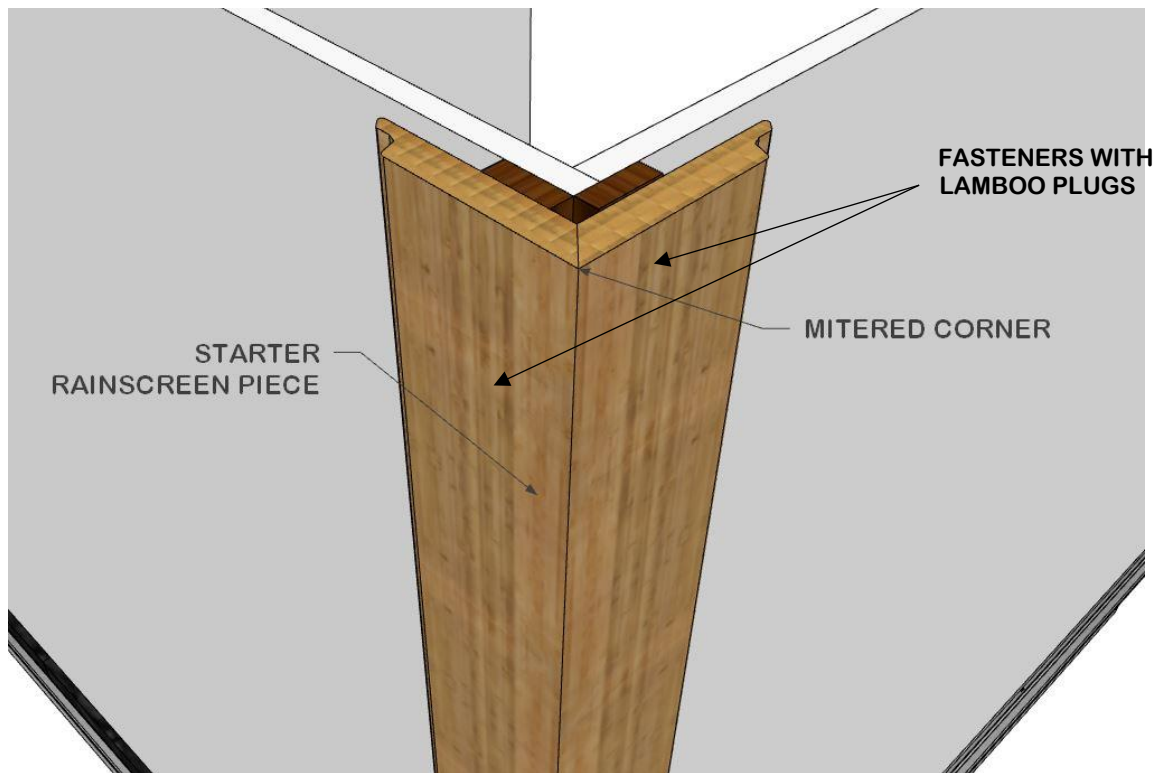

**(Miter Detail:)**

*\* NOTE: For typical outside corner conditions, the Lamboo Rainscreen materials are mitered onsite. A stainless steel fastener is spaced every 36 inches can be used to help secure the corners to keep them stable and in place. It is also recommended that Lamboo Titan Clips are positioned as close to the outside or inside corner to help maintain closure and uniformity of the mitered corners.*

*If using Engineered Outside or Inside Corners, rip cutting the board to width is acceptable.*

**IMPORTANT: ALL CUT EDGES MUST BE SEALED!!!**

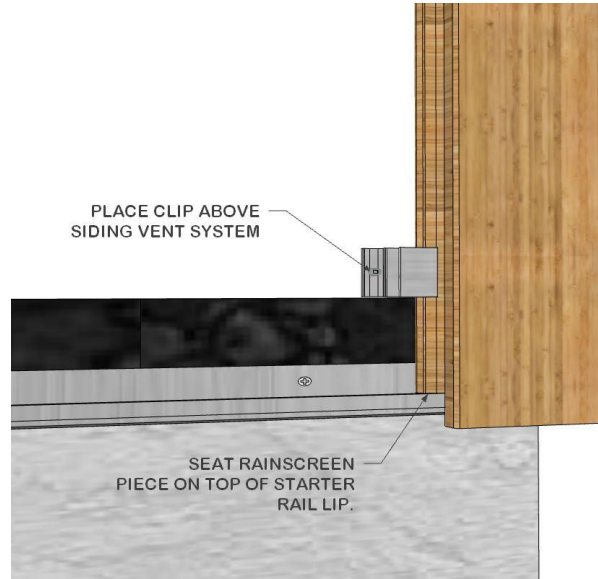

**1<sup>st</sup> Piece Installation:**

**Step 8 - Repeat the assembly process for each vertical row of siding.** Use the Lamboo Titan Clips spaced every 24" to 32" on center (O.C.). As you approach the top of the wall near the soffit, be sure to place the clips as close to the top of the wall as possible to help with stability. For vertical wall heights greater than 16'-0", a second row of starter rail will be required to install materials above the first rows of the rainscreen. Reference CAD details in Lamboo's Resource Library on Lamboo's website under Exterior Products/Bamboo Siding and Soffit/Rainscreen Transition Detail using Z-Girts.

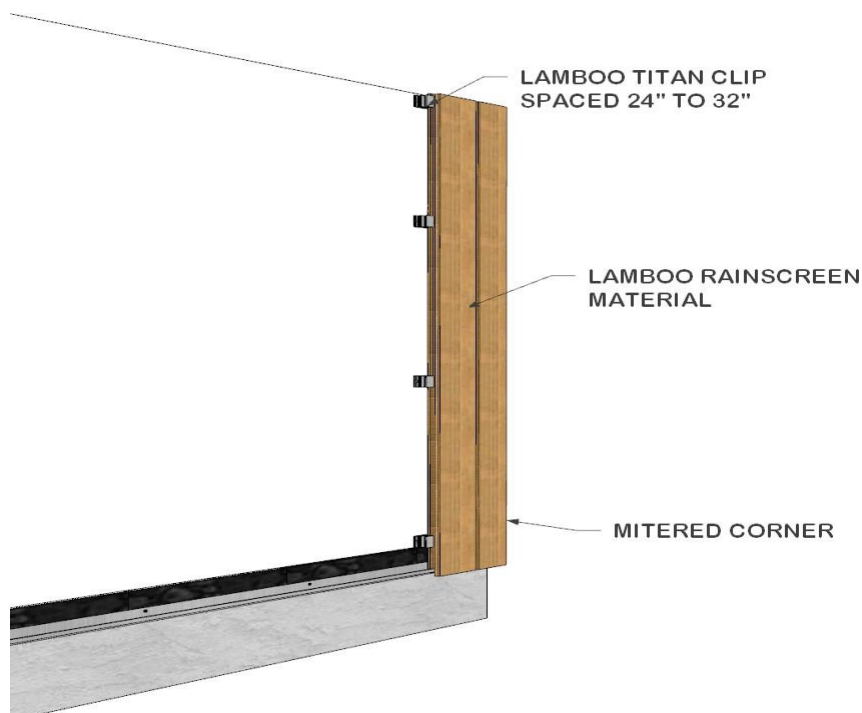



*\*Important Note – Always apply Anchor Seal or similar end sealer product immediately after cutting any Lamboo® boards. This will help minimize potential end-checking of your siding boards*

**Step 9 - Installing the top end of siding.** When you reach the soffit (or areas below window openings), it is necessary to trim the top end of the Lamboo® siding to the appropriate length. You must seal the cut ends of rainscreen with an end sealer, touch stain, paint, or exterior silicone to minimize end checking of the siding boards. For best results, the rain screen clips need to be installed at the top of the boards and the siding vent installed just below the clips.

A trim piece can be used at the top of the rainscreen system if desired when rainscreen does not transition through the soffit.

Thank you again for purchasing the Lamboo® Rainscreen™ System for your project. If you have any further questions that this installation guideline may not answer, please feel free to contact Lamboo and speak to a product specialist. Please contact us via our website at [www.lamboo.us](http://www.lamboo.us) or directly by phone at 866-966-2999.

**Note:** *All information as provided in this document is strictly for reference and is not warrantied or guaranteed by Lamboo. Lamboo does not present any implied warranties as part of this document and will not be held accountable based on the information as presented in this document. This document is for reference only.*

**END OF DOCUMENT**